

Sharp Top Chain 10



Features & Advantages



- Electroplating makes chains more robust, and impact-resistant and enhances the durability and load-bearing characteristics of carbon steel

Technical Specifications

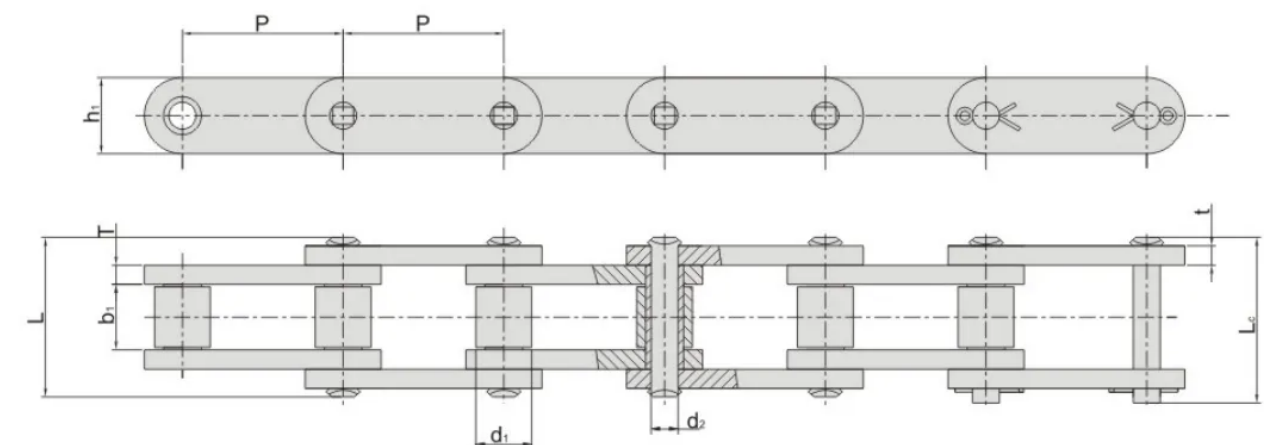

Email | sales@hdsusa.us

Tel | +1 (832) 808-5116 Tel | +1 (832) 808-5164



HDS Chain No.		81X	81XH	81XHH	81XHH	500R	
Pitch	P/mm	66.27	55.27	66.27	66.27	66.27	
Roller Diameter	d1(Max)	23	23	23	23	23	
Width Between Inner Plate	b1(Min)	27	27	27.78	27	27	
Pin Diameter	d2(Max)	11.1	11.1	11.1	11.1	11.1	
Pin Length	L(Max)	49	60.7	65.6	63.6	63.6	
Pin Length	Lc(Max)	53.5	65.1	70	68	68	
Inner Plate Depth	h2(Max)	28.5	31.35	31.35	31.8	31.8	
Plate Thickness	T	4	7.5/5.55	7.5	7.6	7.6	
Ultimate Tensile Strength	Q(Min) KN	106.7	157.9	191.1	152	152	
Average Tensile Strength	Q KN	128.9	175.7	212.6	177.2	177.2	
Weight Per Meter	Q KG/M	3.77	5.79	6.43	6.55	6.55	