

CA Series Roller Chains



Features & Advantages



- HDS Agricultural roller chains are built with special steel rollers enhancing rotation on the bushing while reducing risk of wear and tear on the sprocket
- Optimized Heat Treatment Process
- All chain components are well surface-treated to achieve maximum strength and wear and fatigue resistance
- Agricultural chains are precisely Pre-loaded during manufacturing to minimize its initial elongation and improve its performance dramatically
- Chain plate: Made of high-quality medium carbon steel
- Electric plating technology makes our agricultural chains even stronger and more impact-resistant, increasing the durability and load-bearing features of Carbon Steel, which is a good choice to make as well Environmental protection super wear-resistant grease imported from Germany
- All components are manufactured to exact tolerances to provide optimal performance

Technical Specifications

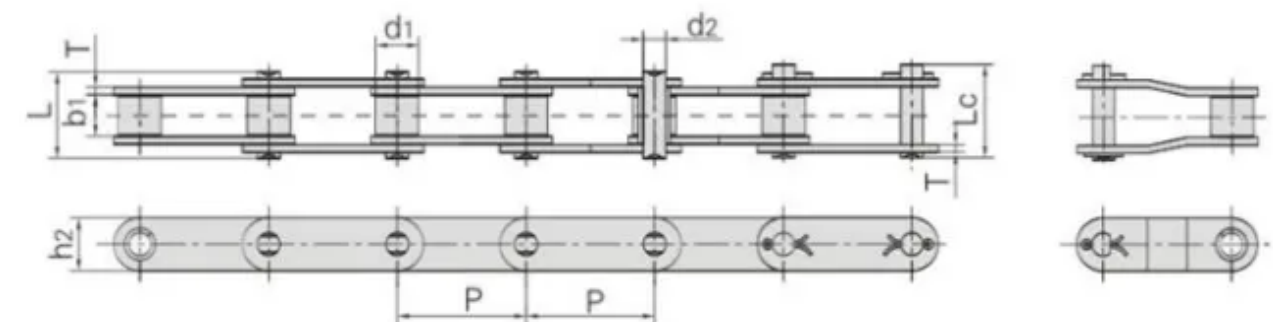

Email | sales@hdsusa.us

Tel | +1 (832) 808-5116 Tel | +1 (832) 808-5164



HDS Chain No.		CA550	S55	CA555	CA550HD	CA550R	CA550V	CA550RV	CA557	CA620	CA2801
Pitch	P/mm	41.4	41.4	41.4	41.4	41.4	41.4	41.4	41.4	42.01	30
Roller Diameter	d1(Max)	16.7	17.78	16.7	16.7	16.87	17.78	16.87	17.78	17.91	15.88
Width Between Inner Plates	b1(Min)	20.1	21.6	12.7	19.5	19.1	22.23	19.81	20.4	14.5	19.05
Pin Diameter	d2(Max)	7.16	7.16	7.16	8.28	8.28	8.28	8.28	7.92	7.16	8.28
Pin Length	L(Max)	34.8	36.7	29.7	35.8	35.6	39	39	37.1	42.3	35.6
Pin Length	Lc(Max)	37.4	39.3	32.4	38.5	38.5	42	42	39.7	45	38.5
Inner Plate Depth	h2(Max)	19.05	19.05	19.05	20.1	20.2	20.2	20.2	23.1	19.05	19.05
Plate Thickness	T(Max)	2.65	2.65	2.65	3.05	3.05	3.05	3.5	3.05	3.25	3.25
Ultimate Tensile Strength	KN	40	40	60	42.1	42	42.1	50	62	39.1	47.1
Weight Per Meter	KG/M	1.9	2.09	1.83	2.05	2.11	2.37	2.39	2.52	2.49	2.5